

WARNING

If the filling is not done immediately:
ballast the tank with a minimum of 5 cm of liquid

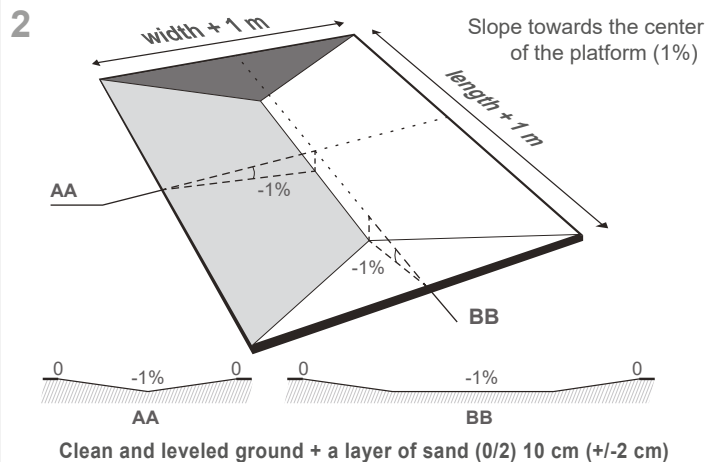

3

IMPORTANT

Installation of the tank according to its volume

V. (m ³)	Number of people
1 to 180	1 to 2
180 to 480	3 to 4
480 to 700	4 to 6

It is **strictly forbidden** to handle the product with machines to avoid any deterioration

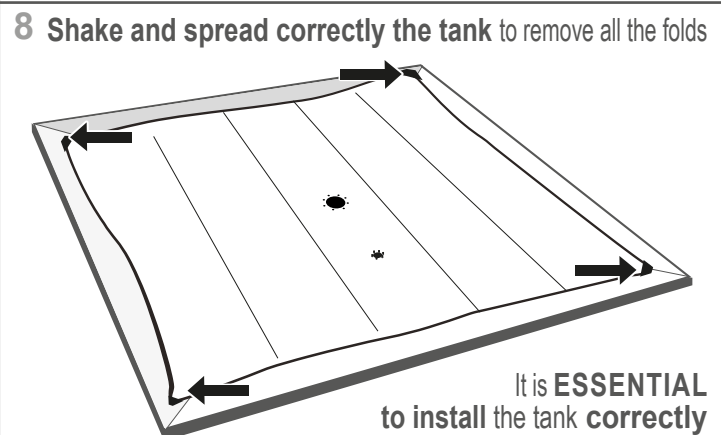
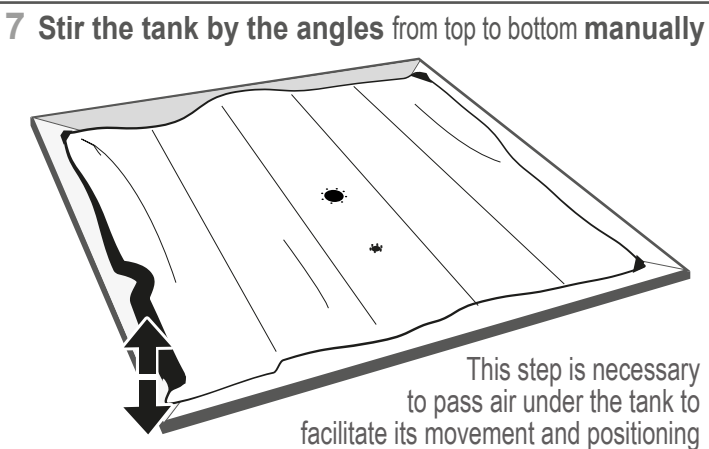
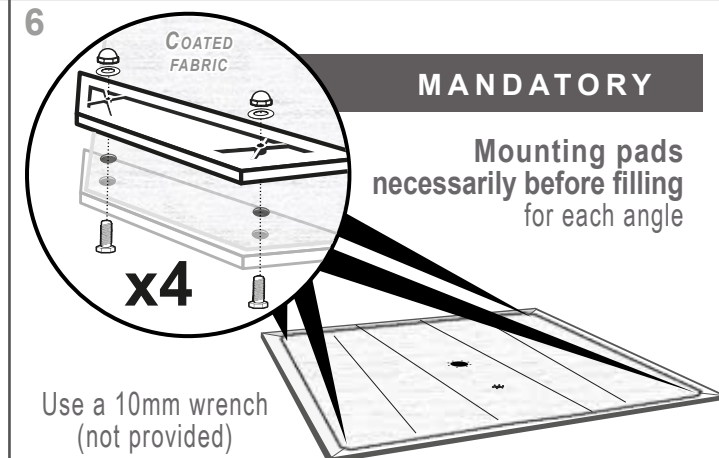
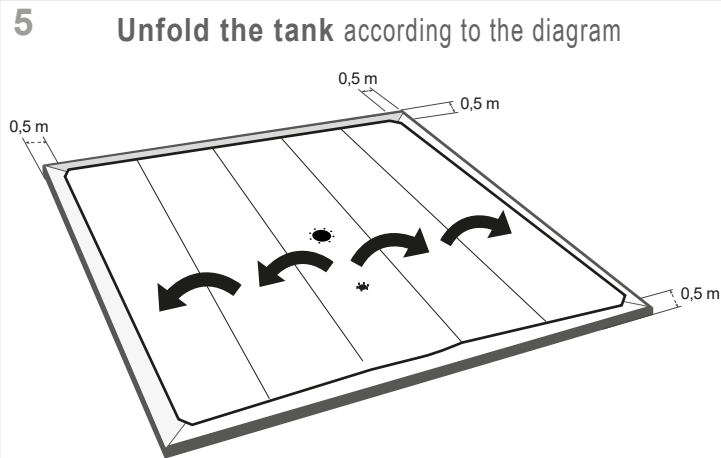
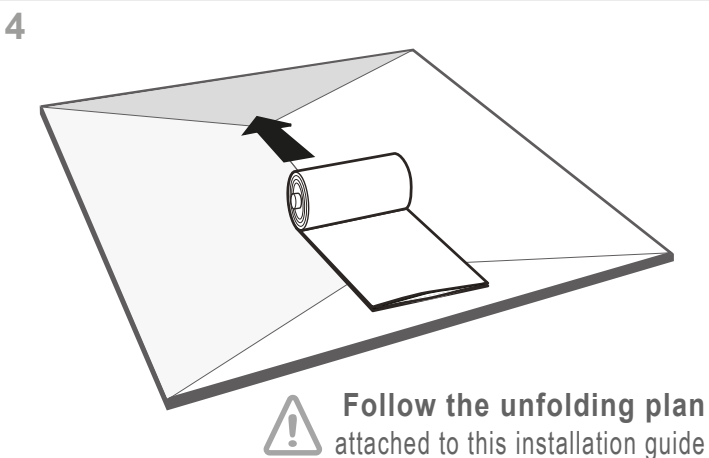

9 FOR ALL THE INLETS/OUTLETS

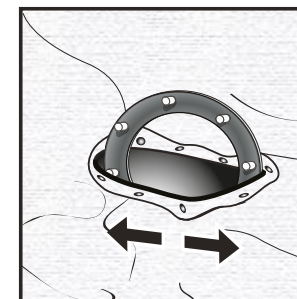

STRETCH WITH CARE
without tools, in order to pass inside the counterflange with its seal

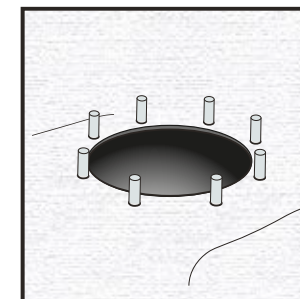

Install correctly the counterflange
in its socket

